

**Hallenpläne**  
Messe Villingen-Schwenningen

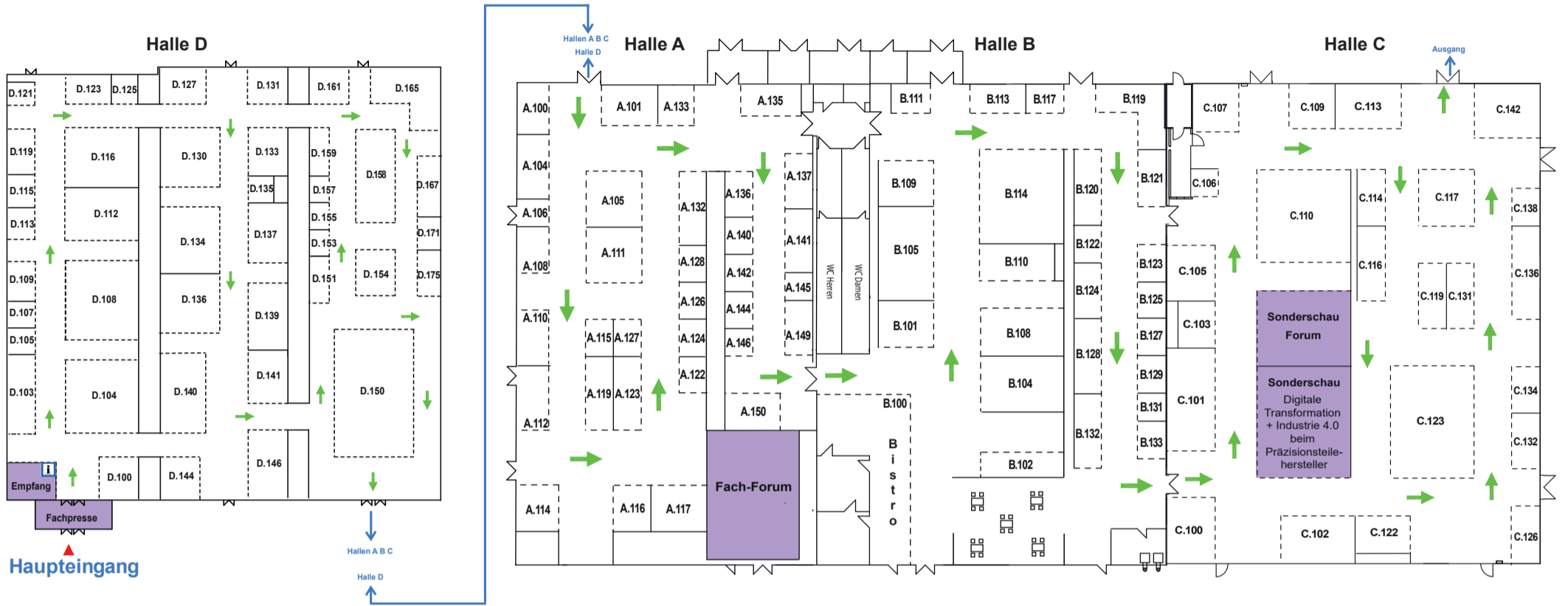

Änderungen vorbehalten  
Stand: 11.10.2021

**Aussteller-Übersicht**

Aussteller Stand-Nr.

A	E	I	N	T
314-Automation C.126	Ebinger A.100	IBAG A.142	Neuberger C.107	TAJMAC C.101
A & U Geiger C.107	Ecoclean B.113	IBT C.136	<b>O</b>	Teamtec A.117
AFS B.120	econsteel B.108	IEMCA D.150	oelheld A.126	Technology Mountains A.141
Albrecht Präzision C.138	ECOROLL A.135	IHK A.141	Otto Bitzer C.117	TIXIT Bernd Lauffer A.110
ALESA A.119	EMUGE D.167	Imoberdorf D.113	<b>P</b>	Top Automazioni C.123
AMF D.105	ENDO INDUSTRIAL A.127	IPZ-Tooling D.171	PRESTERA D.115	Tornos D.130
AMPECT A.133	ESA Eppinger D.109	IVO Oesterle D.159	<b>Q</b>	TRUMPF D.131
APODIS D.123	esgemo D.135	<b>J</b>	QPT D.153	<b>U</b>
Armin Hamma D.150	EWS Weigele C.117	Jäger-Engineering D.107	<b>R</b>	Uldrian B.109
ARNO D.154	EZset C.117	JBS System D.115	RDMO C.109	ultraTEC C.123
ATE TOOLS D.155	<b>F</b>	JöWe C.131	Reber C.116	<b>V</b>
<b>B</b>	Fanuc D.150	Jurjanz D.153	REMMEL Consulting D.157	VARGUS B.101
Baublies A.149	f.britsch D.103	<b>K</b>	Rudi Knopp A.112	Vicivision C.122
Bayer Diamant A.149	Fetzer B.102	Kärcher B.128	<b>S</b>	u.B.117
Bedrunka & Hirth A.119	FMB Maschinenbau D.112	Karl Neißner B.129	SALA LINEA D.157	Vision Engineering A.146
Blaser Swisslube D.175	Forplan C.123	Kerger Tools A.128	Schlenker A.137	<b>W</b>
Blum-Novotest A.104	FRANKEN D.167	Kessler A.119	Schneider Messtechnik A.132	W Mauch C.123
Breuning D.133	<b>G</b>	Keyence B.124	SCHUNK D.150	Wagner Tooling A.149
Büchel C.119	Ganter & Neher B.111	KIPP C.103	Schwabold B.123	WAITKUS C.102
SF-Büchele D.112	Georg Noll D.158	K&K B.101	Schwanog B.125	WECO D.108
BUK TEC D.125	GEWATEC C.102	KNOLL D.137	SGM Schut C.134	WEISS A.145
Bürk-Kauffmann D.151	GNT SYSTEMS D.161	Kohler B.119	Sixt C.123	WEMCO C.110
<b>C</b>	Gölsenbodt B.127	<b>L</b>	SolidCAM C.114	W&F D.150
Carl Benzinger C.123	Ernst Graf D.150	LIQUI Filter A.144	Sphinx D.127	Willi Schüler B.132
CEPA Zentrifugen A.108	Ernst Graf D.150	Lörken A.106	Stainless FRÜCHTL B.122	Wifög A.140
Chrom-Schmitt A.101	Grauer & Karsten D.141	<b>M</b>	STALEX C.123	Wolf C.132
Citizen Machinery D.116	GS Industrietechnik C.123	Mack A.116	STAR D.104	WSF B.105
CNC-Service Ulmer D.139	Gühring D.134	MAFAC A.114	STOCKMEIER B.131	<b>Z</b>
Comretix A.123	<b>H</b>	MAFRA MAILE D.121	Storz SMT A.136	Zorn C.113
<b>D</b>	HAKOS B.121	majesty A.123	Straus D.135	ZWT Zisterer C.105
DC SWISS A.119	Haller A.124	MAS B.104	Studenroth D.119	
Dieterle B.110	Haller-Jauch B.133	MATO B.114		
DIXI A.105	HAMESO A.115	Matzek D.100		
DMG MORI D.150	Hampp Tools D.127	Mauth D.144		
DREHERtec C.100	Härtereie Rau C.106	MAW A.122		
	HB microtec B.104	Mikron C.117		
	HB TURNKEY D.146	Motorex D.151		
	Hengst-Kessler D.136	müga C.140		
	Hermann Bantleon A.150	Müller Hydraulik C.142		
	Hobe A.111			
	Paul Horn D.150			

Änderungen vorbehalten  
Stand: 11.10.2021